



Town of Greenwich
Department of Parks & Recreation - Facilities
Town Hall – 101 Field Point Road - Greenwich, CT 06836-2540
Phone: (203) 622-7814 - Fax: (203) 622-6494

HAVEMEYER FIELDS & GREENWICH COMMONS

Location: Off Greenwich Avenue - behind Town Hall

Directions from
Town Hall: Upper Havemeyer Field: Behind Town Hall
Lower Havemeyer Field: Behind Town Hall
Greenwich Common Pocket Park: Next to Board of Education
on Greenwich Avenue

Size: 7.97 Acres

Hr. of Operation: Dawn to Dusk

Parking: Greenwich Ave. -Board of Ed. Lot,- Town Hall Parking lot

FACILITIES

Greenwich Common Pocket Park

- A. 8-8' wooden benches (poor)
- B. 1 water fountain
- C. 1 stone Sculpture (Man & Woman)
 - C 1. 2 - 2.5' bronze Sculpture of Boys on Rocks
- D. 1 stone Plaque - (C.A.W.C. -Fred Durante)
- E. 1 - 5' mill stone
- F. Approx. 520' x 6' Brick sidewalks
- G. 4 - 30' sections of metal sidewalk railing
- H. 3 perm. Refuse containers, 7 temp. refuse containers

Children's Play Area:

- A. 1 - climbing Apparatus (metal & plastic)w/ 2 sliding boards and 5 climbing rings, 20' x 28' -with wood mulch base border with 42' x 33' railroad ties

Soccer Field:

- A. 300' x 160'
- B. 2 Goals with 2 nets

Veterans Memorial (good)

- A. 50' x 50' area
- B. 2 metal & wood 6' benches
- C. 6 Flood Lights
- D. 1 Flagpole

HAVEMEYER FIELD

I. H.F. Hard Ball: (fair)

- A. Dimensions:
 - L.F. - 348'
 - C.F. - 359'
 - R.F. - 306'
- B. L.F. side - 2 - 8' players benches
R.F. side - 2 - 8' players benches
1 - 12' bleacher - 5 rows
- C. Back Stop - 18' x 16' x 18'
- D. 1 water fountain
- E. Electronic Scoreboard
- F. 1 wooden equipment shed - 8' x 18'

II. Track and Temp. Soccer Field: (good)

- A. Cinder Track - 440 yard.
- B. 1 temp. soccer field (330' x 160') w/ 2 goals & 2 nets
- C. 2 temp. Port-a-sans
- D. 1 - 12' entry gate (metal)

III. Senior Center:

- A. Front - 7- 6' wood and metal benches
- B. Courtyard terrace (34' x 44')
- C. 85' x 10' concrete planter
- D. 12' x 12' concrete planter
- E. 85' x 16' attached bench seat - wooden
- F. 6' x 6' wooden tables-attached to concrete base

Town Hall, Havemeyer Field, and the Common (16.3 acres)

Located in central Greenwich between Greenwich Ave. and Field Point Road, the open space beside and behind the Building housing administrative offices of the Board of Education over to the new Town Hall is reached by lighted walkway from Greenwich Ave. or the rear of Town Hall.

Parking is available close to the area, in the metered lot north of Town Hall, on Greenwich Ave. or next to the Board of Education (Havemeyer Building). The Common, which is the greensward immediately adjacent to Greenwich Ave. is open to the public, as is the Children's playground and the soccer field which lie behind it. The fenced area known as Havemeyer Field, directly behind Town Hall is maintained for competitive sports and here permits from the Department of Parks & Recreation are required.

The Common's convenient benches are used frequently on warm days when people "catch rays" while eating their brown bag lunches. Musicians and other entertainers perform here during the summer months. Holiday parades down Greenwich Ave. often end here and other special events draw crowds.

Green Fingers Garden Club donated the landscaping and children's playground equipment behind the Common, and the Alliance Francaise enhanced the War Monument with plantings.

Tall trees, including tremendous Oaks, one of them the largest Pin Oak in New England, and a copper Beech, shade the benches or edge the playing fields in the wide open spaces used by students from Havemeyer School and Greenwich High. From Greenwich Ave. the land slopes down to Havemeyer Field. On the opposite side it drops precipitously from the parking area behind Town Hall.

In 1979, Town Government offices moved into the renovated building that had served as Greenwich High School since 1926. The Department of Parks & Recreation maintains two large flower beds bordering the broad entrance walk, which bears a profusion of flowers from spring to late fall. A large evergreen tree at the northwest corner of the site is lighted annually when it serves as the Town's Christmas Tree.

Office workers, children on outings, teenage athletes, residents from the nearby Mews, artists from the Arts Center and Seniors from the Senior Center across the street, apartment dwellers whose buildings overlook the park as well as passersby on Greenwich Ave. - all take pleasure in this greenspace in central Greenwich.

Ruth Sims

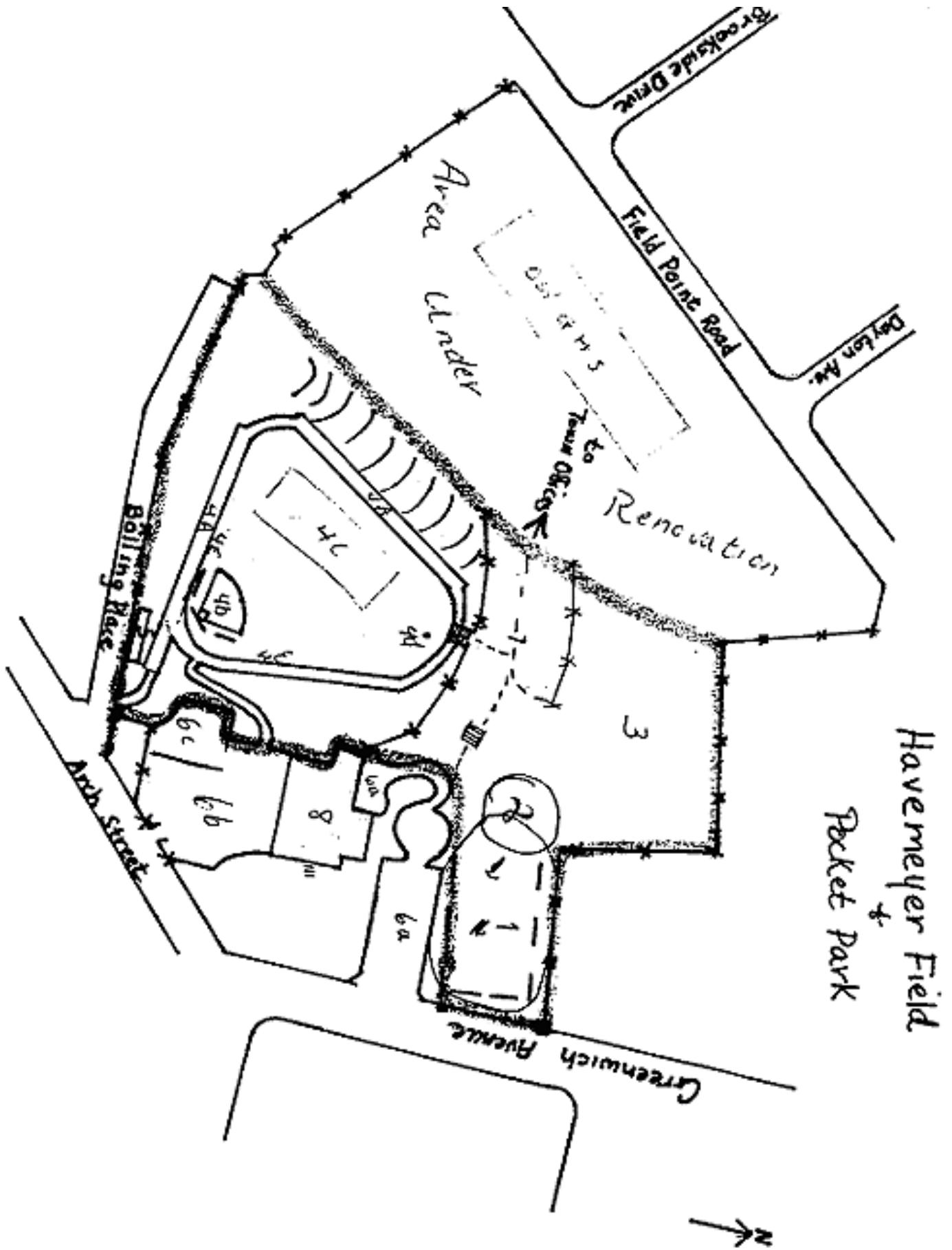

Havemeyer & Greenwich Common Map Key

1. Park Area w/ benches
2. Children's climbing apparatus
3. Soccer field
4. Athletic field
 - a. Cinder track (440)
 - b. Hardball field
 - c. Football field
 - d. Water fountain (temp)
 - e. Bleachers
5. Parks & Recreation Equipment Shed
6. Parking Areas
 - a. 45 cars
 - b. 45 cars
 - c. 15 cars
7. Sidewalk
8. Havemeyer Building